

RUSSELL STREET

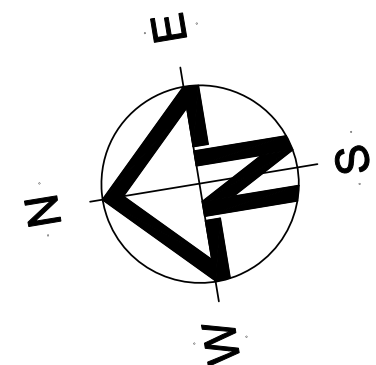
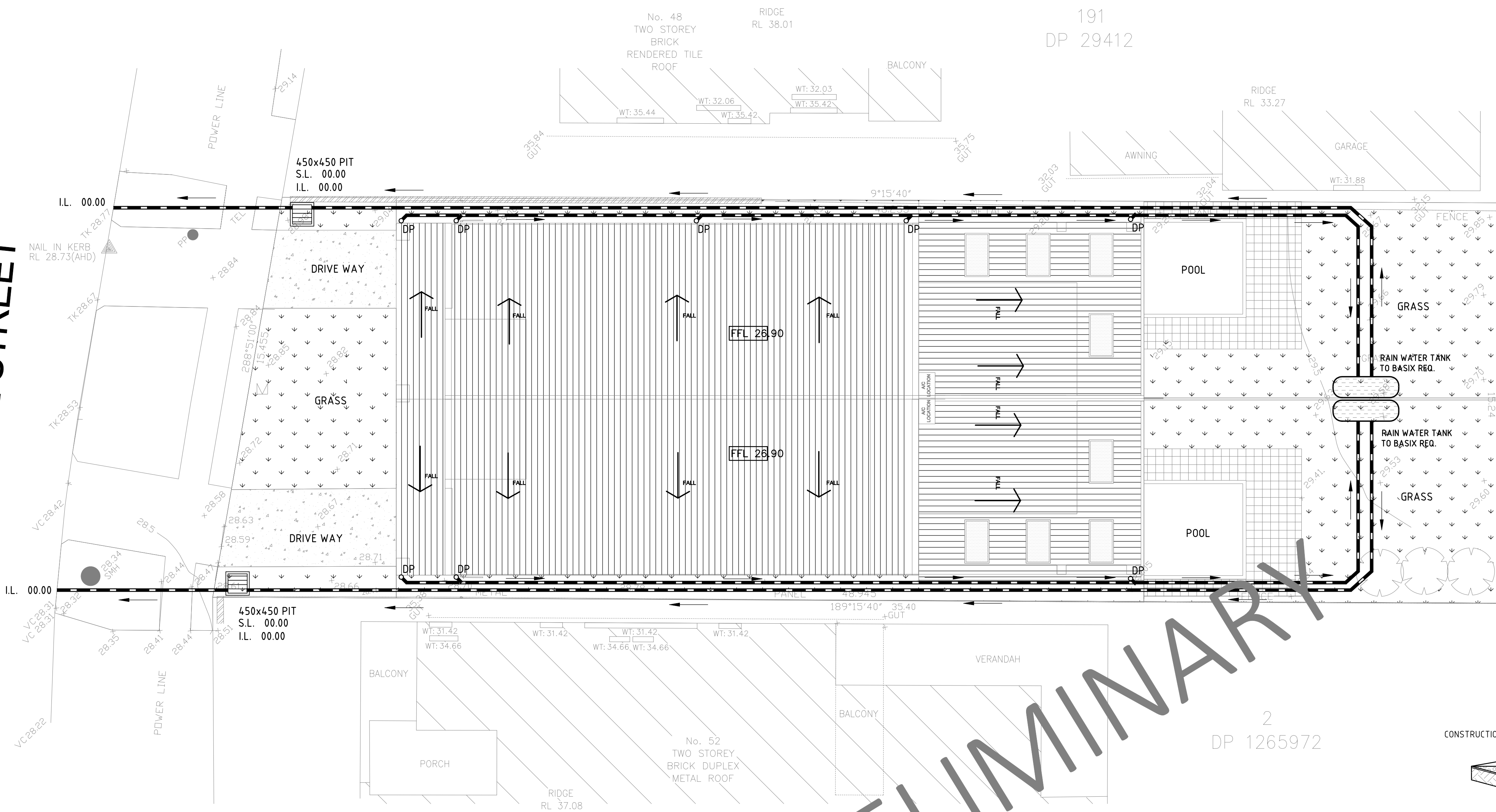

GENERAL DRAINAGE NOTES:

1. THIS DRAINAGE PLAN SHOULD BE READ STRICTLY IN ACCORDANCE WITH THE COUNCIL APPROVED ARCHITECTURAL PLANS
2. LOCATIONS OF DOWN PIPES TO BE CONFIRMED BY THE ARCHITECT
3. DEPTH AND LOCATION OF SERVICES TO BE ESTABLISHED PRIOR TO COMMENCEMENT OF DRAINAGE WORKS.
4. ALL GUTTERS TO BE MIN STRAMIT 115 QUAD OR EQUIVALENT
5. ALL BALCONIES TO HAVE FLOOR WASTE CONNECTED TO DOWNPIPE
6. ALL DRAINAGE PIPES ARE TO BE UPVC GRADE, UNLESS NOTED OTHERWISE.
7. THE MINIMUM COVER OVER ALL DRAINAGE PIPES IS TO BE 150mm.
8. ALL DRAINAGE PIPES ARE TO HAVE A MINIMUM PIPE GRADIENT OF 1%
9. ALL DRAINAGE PITS ARE TO BE INSTALLED WITH A CHILD PROOF SAFETY LATCH ON THE ACCESS GRATE.
10. ALL DOWNPIPES ARE TO BE 100 x 50 SQUARE BOX SECTIONS UNLESS NOTED OTHERWISE
11. ALL PITS TO BE CONSTRUCTED ARE SHOWN IN REINFORCED CONCRETE, HOWEVER PRECAST OR BRICK PITS OF SIMILAR SIZE AND CONSTRUCTION AND TO THE SAME LEVELS ARE ACCEPTABLE.
12. ALL EXTERNAL IMPERVIOUS AREAS TO HAVE A COLLECTION OUTLET TO THE ABSORPTION TANK

31
DP 16437

30
DP 16437

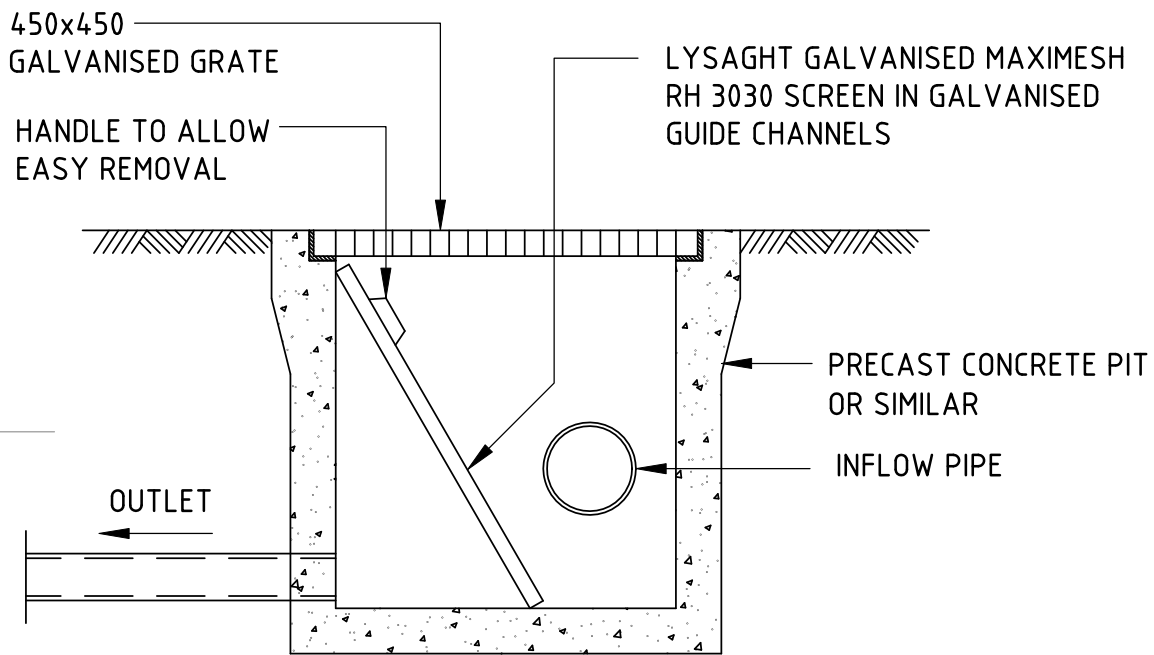

SILT ARRESTOR PIT (SAP)

N.T.S.

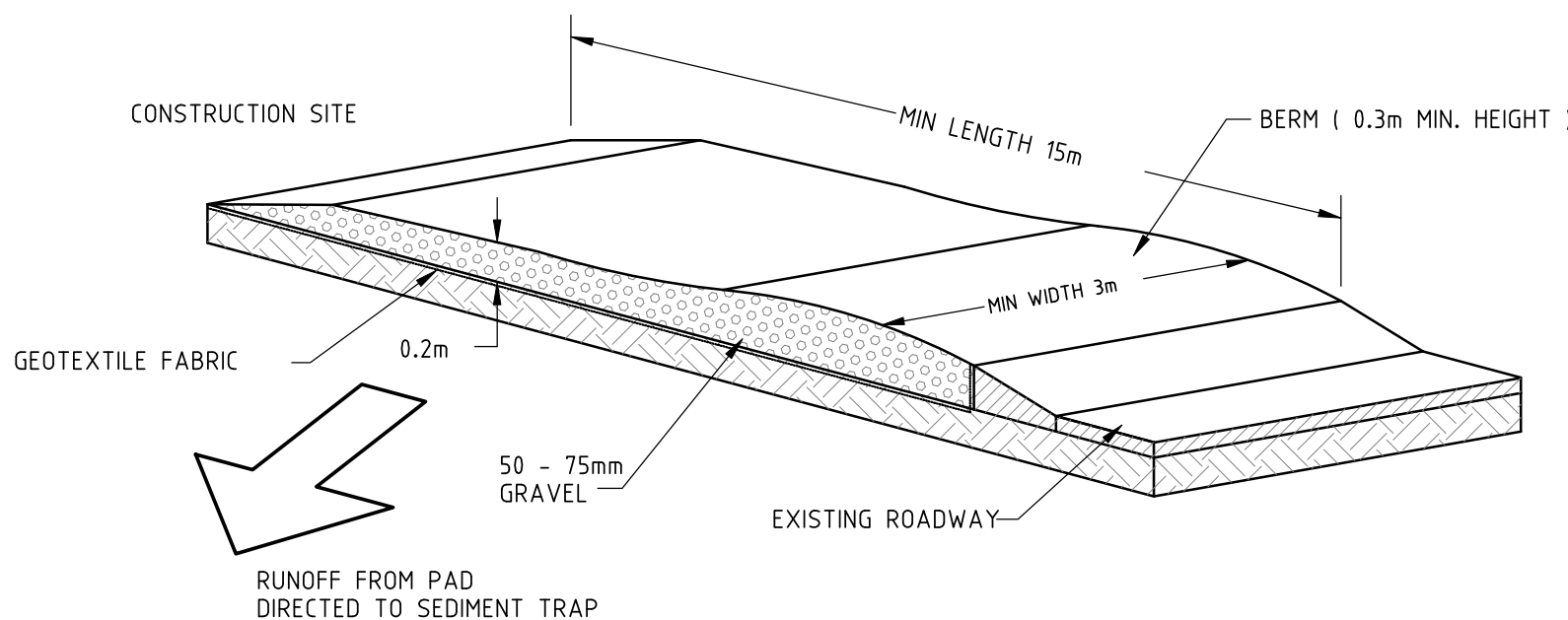

TEMPORARY SITE CONTROL FOR ENTRY / EXIT AREAS

1. THE ENTRANCE SHALL BE MAINTAINED IN A CONDITION WHICH WILL PREVENT TRACKING OF SEDIMENT ONTO PUBLIC ROADS.
2. PERIODIC TOP DRESSING WITH ADDITIONAL AGGREGATE MAY BE REQUIRED TO KEEP THE SITE CONTROL IN A 'USEABLE STATE'.
3. ALL SEDIMENT SPILLED, DROPPED OR WASHED ONTO PUBLIC ROADS MUST BE REMOVED IMMEDIATELY AND CHECKED DAILY.
4. REMOVAL AND CLEANING OF PUBLIC ROADS BY BROOMS AND SHOVELS ETC.. WASHING DOWN ROADS IS NOT PERMITTED.

EROSION CONTROL MEASURES.

1. ALL EROSION AND SEDIMENT CONTROL MEASURES, INCLUDING RE-VEGETATION AND STORAGE OF SOIL AND TOP SOIL, SHALL BE IMPLEMENTED TO THE DEPARTMENT OF CONSERVATION OF NEW SOUTH WALES STANDARDS.
2. TOPSOIL FROM ALL AREAS TO BE DISTURBED, SHALL BE STOCK PILED AND LATER RESPREAD TO AID VEGETATION.
3. ALL DRAINAGE WORKS SHALL BE CONSTRUCTED AND STABILISED AS EARLY AS POSSIBLE DURING DEVELOPMENT.
4. SEDIMENT TRAPS SHALL BE CONSTRUCTED AROUND ALL PITS.
5. DISTURBANCE TO VEGETATION SHALL BE LIMITED TO FILL AREAS, ROADWAYS AND DRAINAGE LINES. AREAS OTHER THAN SPECIFIED SHALL BE DISTURBED ONLY WITH PRIOR APPROVAL FROM THE COUNCIL ENGINEER.
6. ALL DISTURBED AREAS SHALL BE REVEGETATED AS SOON AS THE RELEVANT WORKS ARE COMPLETED.
7. ALL SEDIMENT BASINS AND TRAPS SHALL BE CLEANED WHEN THE STRUCTURES ARE A MAXIMUM OF 60% FULL OF SOLID MATERIALS, INCLUDING DURING MAINTENANCE PERIOD.
8. A STRIP OF TURF BEHIND AND FOR TOTAL LENGTH OF ALL THE KERBS SHALL BE PROVIDED.
9. PIT GUARDS SHALL BE INSTALLED AROUND DRAINAGE PITS AT THE COMPLETION OF ROAD WORKS.

SEDIMENT CONTROL DEVICES.

1. ALL HAY BALES SHALL BE BOUND WITH WIRE. HAY BALES SHALL BE PLACED END TO END IN A SINGLE ROW AND EMBEDDED INTO THE SOIL TO A DEPTH OF 100mm. EACH BALES SHALL BE SECURELY ANCHORED WITH TWO STEEL STAKES DRIVEN 600mm INTO THE GROUND AND LOCATED ON THE BALE CENTERLINE.
2. FILTER FENCE SHALL BE CONSTRUCTED BY STRETCHING A FILTER FABRIC (PROPEX OR SIMILAR) BETWEEN POSTS AT 3m CENTERS MAXIMUM. FABRIC SHALL BE BURIED INTO THE GROUND 200mm ALONG ITS LOWER EDGE.

STORMWATER DRAINAGE LAYOUT
EROSION & SEDIMENT CONTROL PLAN

1:100

LOCATION OF DOWN PIPES TO
BE CONFIRMED BY THE ARCHITECT

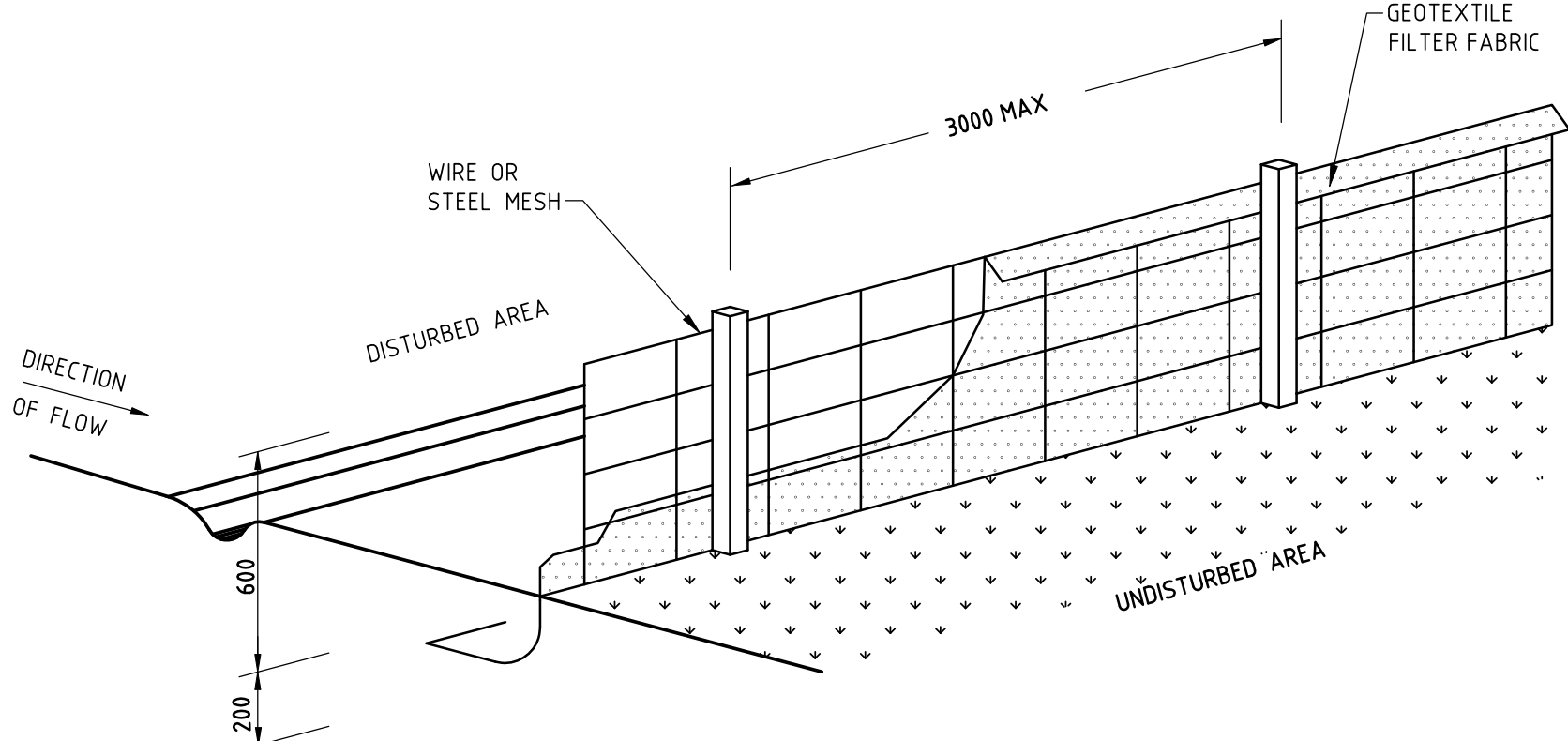
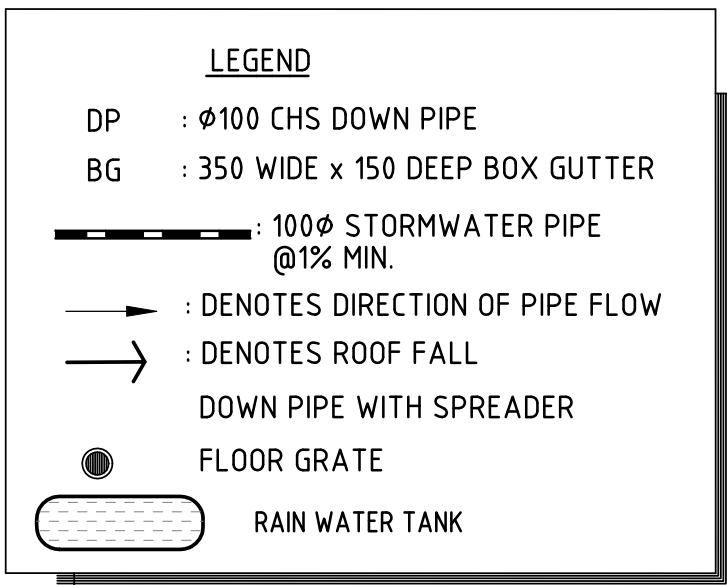

SEDIMENT FENCE

1. TO BE USED AS A TEMPORARY BARRIER TO INTERCEPT SEDIMENT LADEN RUN-OFF FROM SMALL DRAINAGE AREAS
2. MAXIMUM DRAINAGE AREA FOR OVERLAND FLOW TO A SILT FENCE SHALL NOT EXCEED 0.6Ha PER LINE OF FENCE.
3. DO NOT USE IF CONCENTRATED FLOW IS DIRECTED TO SILT FENCE.
4. MAXIMUM ALLOWABLE DISTANCE BETWEEN SILT FENCE FOR VARIOUS GRADES LISTED BELOW:

SLOPE V:H	MAX. SLOPE LENGTH (m)
1:2	15
1:3	25
1:4	40
1:5	50
FLATTER THAN 1:5	60

Rev.	Date	Description	Rev.	Date	Description
A	25/10/22	ISSUE FOR APPROVAL			

Client:

PTY. LTD.

Soliman Hanna & Associates
Consulting Structural & Civil Engineers
Accredited Certifiers
65A Millet Street, Hurstville NSW 2220
Ph:(02) 9570 1119 Fax:(02) 9570 7738
Email: shanna@shconsulting.com.au

Project:
**PROPOSED DEVELOPMENT
50 RUSSEL STREET
GREENACRE**

Scale: AS SHOWN	Date: 25.10.22
Drawn: LN	Designed: S.H.
Approved By: Soliman Hanna BSEng(Hon),MIEAust,CPEng,NPER-3(633916)	Date:

Title:
**CONCEPT STORMWATER
LAYOUT AND DETAILS**

Job Number: 22-094	
Drawing Number: D1	Revision: A